

[www.brandshatch.co.uk](http://www.brandshatch.co.uk)

BRANDS HATCH  
**2025 VENUE HIRE**

# MOTORSPORT VISION (MSV) OVERVIEW



MotorSport Vision (MSV) is a private UK company owned 75% by its Chief Executive Jonathan Palmer and 25% by Sir Peter Ogden. It is Europe's largest motor racing circuit operator, with six venues in the UK: Brands Hatch, Donington Park, Oulton Park, Snetterton, Cadwell Park and Bedford Autodrome, and a seventh circuit, Circuito de Navarra in northern Spain.

MSV also owns a 1270-acre disused French army base at Couvron in north-east France which is

being redeveloped with a 3.5km new circuit complex, alongside a 750-acre solar park.

MSV's largest project at the moment is redeveloping Donington Hall, a magnificent 62,000 sq ft historic building built in 1791, into a 55-bedroom country house hotel.

MSV is also transforming the adjacent Hastings House building into the state-of-the-art Donington Motorhouse - a prestigious motoring stabling facility. Both due to open in Spring 2026.

# BRANDS HATCH KENT



Brands Hatch is the UK's best-loved circuit. Formed in 1926 as a grass track cycling venue, the Kent track is best known for holding 14 rounds of the Formula One World Championship, alternating the British Grand Prix with Silverstone between 1964 and 1986.

#### Location

Brands Hatch is situated on the A20 London to Maidstone Road near West Kingsdown. Just 3 miles from Junction 3a (Swanley) off the M25, it is linked via the A20 on the M20 and M25/26 motorways. Regular services to Swanley train station (5 miles) operate from London Victoria, Sevenoaks and the Kent coast.

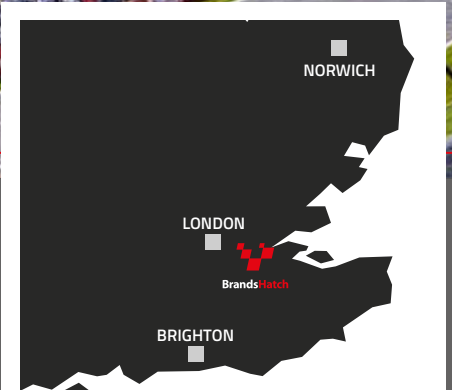

- The circuit has also staged multiple World Superbike rounds plus Indycars, World Sportscars and the Road Cycling events at the London 2012 Paralympic Games
- The circuit is located less than 20 miles from central London off junction 3 of the M25, and boasts excellent transport links



# BRANDS HATCH FACILITIES

## VENUE INFO

### Circuit Configurations

- Indy Circuit - 1.2 miles
- GP Circuit - 2.4 miles

### Additional Activity Areas

- Paddock - 22,000m<sup>2</sup>
- Rally Stage 1 - 750m
- Rally Stage 2 - 600m
- 4x4 Course - 400m
- Expo - 1200m<sup>2</sup>
- Grey Hard Standing - 4240m<sup>2</sup>

### Suites

- Stirling Suite, MSVC  
2nd floor, seats 200
- Clark Suite, MSVC  
1st floor, seats 200
- Cooper Suite, MSV  
1st floor, seats 60
- Sheene Suite, MSVC  
1st floor, seats 60
- Pilgrim's Suite, MSVC  
1st floor, seats 60
- Hawthorn Suite, MSVC  
1st floor, seats 20
- NMC/Media Centre  
seats 100
- Hailwoods Restaurant  
seats 100

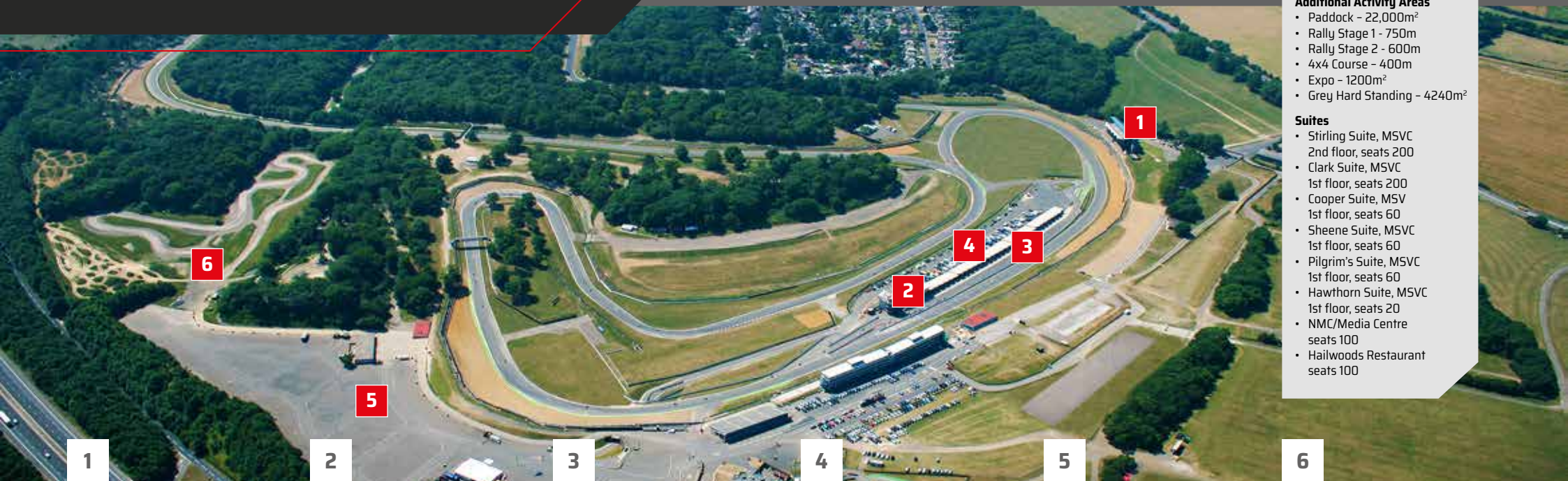

### MotorSport Vision Centre (MSVC)

A purpose-built, trackside conference facility capable of hosting events from 10 to 400 delegates with unlimited parking.

### Nigel Mansell Centre (NMC)

Located above the pit complex, the Nigel Mansell/Media Centre offers a near 360 degree elevated view of the famous Indy Circuit and can accommodate up to 100 guests.

### Pitlane Complex

34 garages (all with front and rear lockable doors) are available at no extra cost for all Indy and GP Circuit events.

### GP Paddock

Situated to the rear of the garages, the GP Paddock is a versatile space that can be used as a dynamic driving/presentation area or simply to park support vehicles.

### Lower Paddock

At 22,000m<sup>2</sup>, the Lower Paddock is a vast area capable of handling a range of activities. This area can be wetted with our onsite bowser to offer a low grip surface.

### Off Road Areas

Two rally stages, a 4x4 course and two large tarmac display/activity areas (Expo and Grey Hard Standing). The GP Loop section of the circuit can also be utilised separately for driving activities.



# BRANDS HATCH THE CIRCUIT



Famous for its unusual topography, Brands Hatch is situated in a natural bowl, nestled deep in the Kent countryside. It features two configurations - the short 1.2 mile Indy Circuit and the 2.4 mile Grand Prix Circuit, which extends deep into woodland and comprises long straights and sweeping corners. The first bend at Paddock Hill is recognised as one of the world's greatest corners, as you plunge steeply downhill into a rapid right-hander.

## CIRCUIT LAYOUTS



### INDY CIRCUIT

Circuit Length - 1.208M / 1.944KM

Left Hand Corners - 2

Right Hand Corners - 5

Pole Position - Right



### GP CIRCUIT

Circuit Length - 2.433M / 3.916KM

Left Hand Corners - 3

Right Hand Corners - 8

Pole Position - Left



# MOTORSPORT VISION CENTRE (MSVC)



Brands Hatch boasts a purpose-built conference and hospitality facility overlooking the circuit, capable of hosting events from 10 to 400 delegates over two floors with unlimited parking. There is also access to a stunning rooftop balcony.

## KEY FEATURES

- Trackside location with unlimited parking
- Set over two floors plus a rooftop balcony over-looking the circuit
- Fully air-conditioned
- Lift access to all floors
- Kitchen facilities on each floor and permanent bar on second floor
- Eight wall-mounted TV screens (four per suite)
- WiFi connectivity throughout the building

## SUITES

- Stirling Suite, MSV Centre, 2nd floor – 37.82m x 12.00m – seats 200
- Clark Suite, MSV Centre, 1st floor – 37.70m x 10.70m – seats 200
- Cooper Suite, MSV Centre, 1st floor – 12.10m x 10.70m – seats 60
- Pilgrim's Suite, MSV Centre, 1st floor – 12.10m x 10.70m – seats 60
- Sheene Suite, MSV Centre, 1st floor – 13.50m x 10.70m – seats 60
- Hawthorn Suite, MSV Centre, 1st floor – 10.50m x 4.50m – seats 20



# MOTORSPORT VISION CENTRE (MSVC) FLOOR PLANS

## FIRST FLOOR

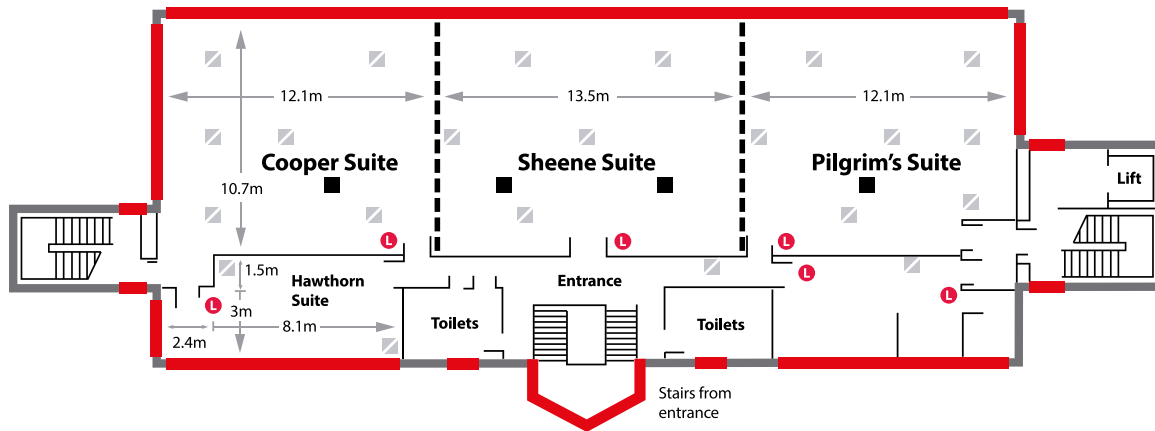

## SECOND FLOOR

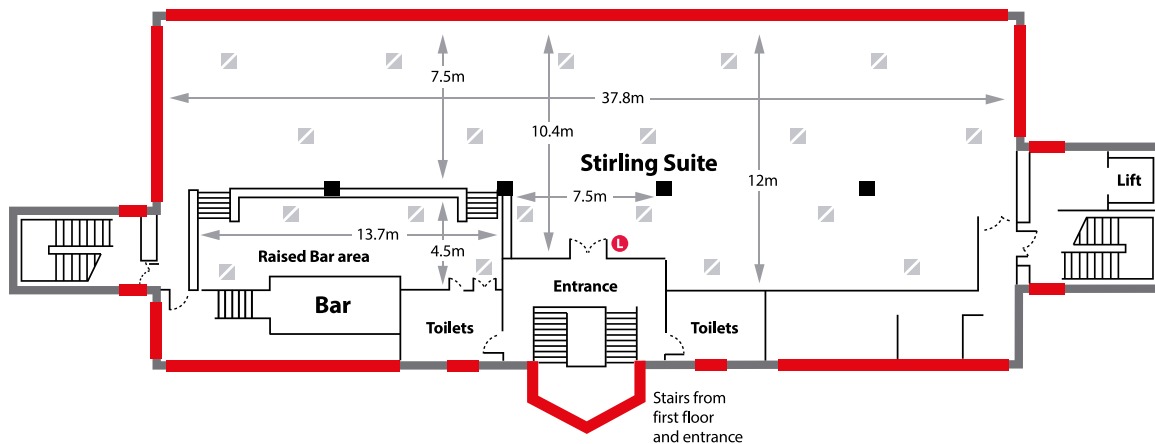

### FLOOR PLAN KEY

- Light Switch
- Dual electrical sockets
- Pillars
- Windows
- Removable partition walls

### Floor Space

Suite	Floor	Length/m	Width/m	Area/sqm	Max Height/m
Clark	1	37.7	10.7	405	2.59
Sheene	1	13.5	10.7	144	2.59
Cooper	1	12.1	10.7	130	2.59
Pilgrim's	1	12.1	10.7	130	2.59
Hawthorn	1	10.5	4.5	43.7	2.59
Stirling	2	37.82	12	454	2.59

### Capacity

Suite	Theatre	Dinner	Dinner Dance	Cabaret	U-Shape	Boardroom
Clark	300	240	200	144	120	
Sheene	100	60		48	30	25
Cooper	100	60		48	30	25
Pilgrim's	100	60		48	30	25
Hawthorn	20	20				20
Stirling	300	240	200	144	120	

## PIT LANE COMPLEX AND GRAND PRIX Paddock



### Pit Lane Complex

Our pit lane and paddock complex includes 34 garages with front and rear lockable doors. The control tower building has additional rooms that can be used as smaller break-out suites or office space.

### Grand Prix Paddock

Situated to the rear of the garages, the GP Paddock is a versatile space that can be used as a dynamic driving/presentation area or simply to park support vehicles.



## NIGEL MANSELL CENTRE (NMC)



The Nigel Mansell Centre above the pit lane offers a prime location right in the hub of the venue. Able to accommodate up to 100 guests, this suite is a 30 second walk away from the pit lane and garages, and offers a near 360 degree view of the famous Indy Circuit.

### KEY FEATURES

- Central pit complex location
- Near 360 degree elevated views of the Indy Circuit
- Fully air-conditioned throughout
- Serviced by a dedicated staircase just 30 seconds from the pit lane
- Kitchen facilities
- WiFi connectivity throughout the building

### SUITES

23.50m x 6.70m - seats 100



## LOWER PADDOCK AND ASPHALT AREAS



At 22,000m<sup>2</sup>, the Lower Paddock is a vast area capable of handling a range of activities and displays running simultaneously. This area can be wetted with our onsite bowser to offer a low grip surface. The Hailwoods restaurant and bar is located in this area and offers toilet and refreshment facilities.

Brands Hatch offers two further large tarmac areas that are suitable for a variety of displays, activities or parking - Grey Car Park and the Expo Site.

The 1.2 mile Grand Prix Circuit loop can also be used independently as a driving activity area when the Indy Circuit is in use.

### SUITES

Lower Paddock	22,000m <sup>2</sup>
Expo Site	1,200m <sup>2</sup>
Grey Car Park	4,240m <sup>2</sup>
Grand Prix Loop	1.2 miles



## OFF-ROAD AREAS



Brands Hatch has two dedicated rally stages, with a mixed loose and asphalt surface. We also operate a purpose-built off road course for 4x4 vehicles.

There are many woodland trials within the infield of the racetrack that can also be utilised.

### SUITES

Rally Stage 1	750m
Rally Stage 2	600m
4x4 Course	400m



## EVENT MANAGEMENT



All of MSV's venues offer high quality facilities available all-year-round which can cater for every type of automotive event. Whether it's a product launch, dealer network training event, or conference with fun driving activities, our venues provide the perfect backdrop and environment.

We also have a highly experienced and dedicated in-house event management team. Our event managers and chief instructors can be involved in everything from the important initial planning phase through to management and delivery of the event itself, to ensure everything runs flawlessly and to the highest standard.



## INSTRUCTORS



As the UK's largest motorsport operator, MSV has direct access to a large pool of highly-skilled instructors who have been rigorously trained.

Our instructors are carefully selected not just on the basis of their driving talent, but for their ability to establish a rapport with guests and to quickly understand their levels of experience and confidence.



## CATERING



From a simple continental breakfast to a sumptuous three-course meal, our in-house catering department prides itself on quality and meticulous attention to detail.

Whilst we have a wide selection of carefully created menus to choose from, we can also accommodate your specific requirements to produce a bespoke menu.



**FOR MORE DETAILS**

**PLEASE CONTACT**

CALL: 01474 875213

EMAIL: [TRACKHIRE@MSV.COM](mailto:TRACKHIRE@MSV.COM)

**[WWW.MSV.COM](http://WWW.MSV.COM)**